

APPROVED PLAN
 PLANNING AND ENVIRONMENT ACT 1987
 CARDINIA PLANNING SCHEME

Permit No.: T180170
 Sheet: 1 of 1
 Approved by: Emily Cook
 CARDINIA SHIRE COUNCIL
 Date: Friday, 1 February 2019

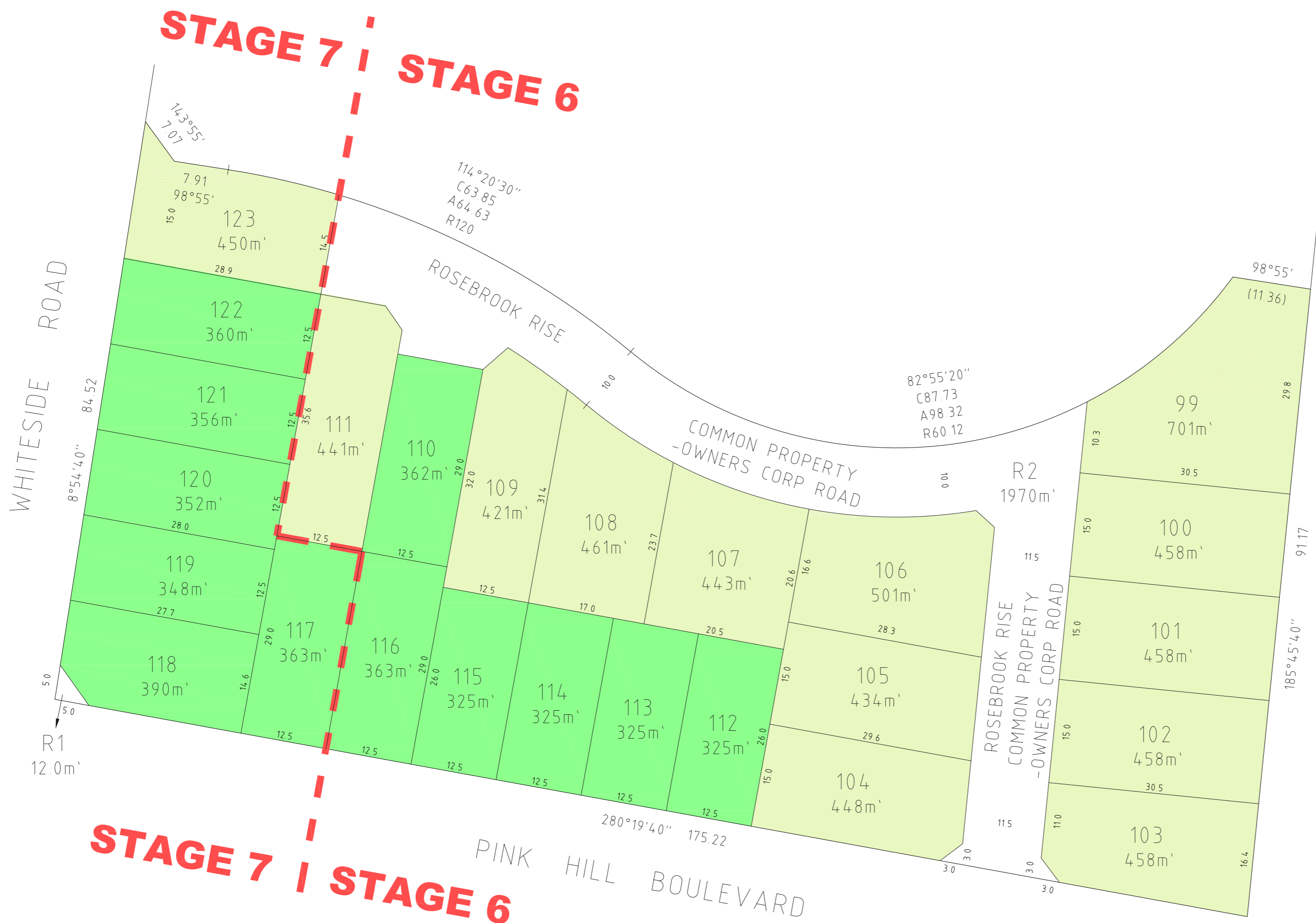

STAGE 7 | STAGE 6

NOTE:

This plan has been prepared as a proposed subdivision to accompany a subdivision application to Cardinia Shire Council and should not be used for any other purpose. The dimensions, areas and total number of lots shown hereon are subject to field survey and also to the requirements of council and any other authority which may have requirements under any relevant legislation. In particular, no reliance should be placed on the information on this plan for any financial dealings involving the land. Not all easements (if any) are shown at this stage. All lots could be affected by easements needed to service this subdivision as required by the appropriate authorities or design engineer.

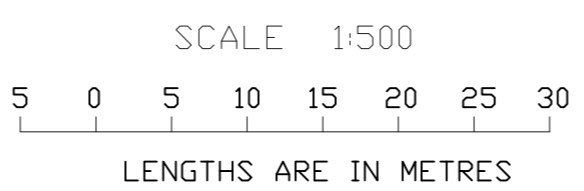

LOT AREA ANALYSIS				
COLOUR	LOT SIZE	No LOTS	AREA	% OF SITE
	< 299m'	0	0m'	-
	300-399m'	12	4193m'	33.98
	≥ 400m'	13	6162m'	49.94
TOTAL No LOTS			25	10363m'
RESERVES & ROADS				1982m'
TOTAL SITE AREA				12338m'
LOT DENSITY 17.0 PER HECTARE				

<p>CRA SURVEY PTY LTD LAND SURVEYORS TOWN PLANNERS DEVELOPMENT CONSULTANTS</p> <p>7A/346 Belmore Road Balwyn Vic 3103 office@crsurvey.com.au Tel: 03 9890 0933</p>	<p>LENGTHS ARE IN METRES</p> <p>DRAWN BY: BR DATE OF SURVEY: VERSION: 4 (15-01-2019)</p>	<p>26 WHITESIDE ROAD OFFICER</p> <p>TITLE: VOL. FOL. LOT A ON PS804256</p> <p>COUNTY: MORNINGTON PARISH: PAKENHAM CROWN ALLOTMENT: 36A(PART)</p>	<p>PLAN OF PROPOSED SUBDIVISION RELEASE-6</p>	
			<p>REF: 4326PP6 ORIGINAL SHEET SIZE : A2</p>	<p>SHEET 1 OF 1 SHEET ORIGINAL SCALE 1:500</p>